

GH-4 series

Latch action toggle clamps are available in three types, with a horizontal, vertical or hook action. The latch action allows two faces to be fastened together on the same plane or at 90°.

They have the advantage of having a low profile and so are most suitable for applications having a height restriction.

The latch action makes this clamp ideally suited for applications on mould box lids, quick release covers, hatches and doors.

Features include:

- Red vinyl hand grip with cushioned rib profile for improved user comfort.
- All body and linkage components on the light duty range are zinc plated to resist corrosion.
- The heavy-duty range has wide flanged bases for strength and rigidity.
- Some latch clamps are fitted with a safety lock feature designed to stop the clamp opening without operation.
- Pivot points are fitted with hardened steel or stainless steel rivets to maintain accuracy and provide a long service life.

Clamps With
Safety Lock

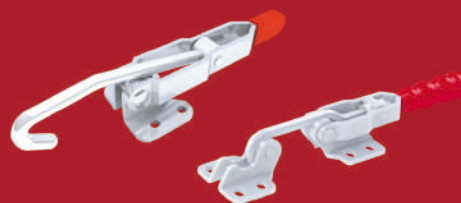
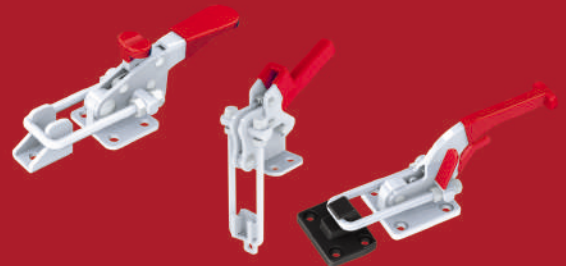

Hook Versions

Horizontal
Versions



Vertical Versions

GH 40323 / 40323-SS

- Holding Capacity 163Kg
- Weight 0.07Kg
- Latch Plate Supplied GH-40323-LP / GH-40323-LPSS

GH 431 / 431-SS

- Holding Capacity 318Kg
- Weight 0.23Kg
- Latch Plate Supplied GH-431-LP / GH-431-LPSS

GH 40341 / 40341-SS

- Holding Capacity 900Kg
- Weight 0.68Kg
- Latch Plate Supplied GH-40341-LP / GH-40341-LPSS

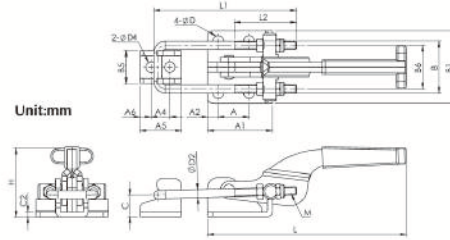

Part No.	A	A1	A2	A4	A5	A6	B	B1	B5	B6	C	D	D2	D4	H	L	L1	L2	M	
40323	15.9	26.2	5.2	9.9	19.8	6	19	28.2	13	19	12	2	4.4	4	4.4	31.3	7.7	5.5	24	M4xP0.7
431	19	39.7	6.4	11.5	25.4	6.8	31.8	44.4	20	26.6	13.5	3	6.7	5	6.3	42	121.8	87.5	38	M5xP0.8
40341	41.3	60.3	9.5	19.1	38.1	9.5	38.1	54	30.2	44.5	23.4	4	8.6	8	8.5	76.1	171.8	114.5	52	M8xP1.25
40323-SS	STAINLESS STEEL																			
431-SS	STAINLESS STEEL																			
40341-SS	STAINLESS STEEL																			

GH 40324 / 40324-SS

- Holding Capacity 225Kg
- Weight 0.09Kg
- Latch Plate Supplied GH-40324-LP / GH-40324-LPSS

GH 40334 / 40334-SS

- Holding Capacity 450
- Weight 0.3Kg
- Latch Plate Supplied GH-40334-LP / GH-40334-LPSS

GH 40344 / 40344-SS

- Holding Capacity 900Kg
- Weight 0.65Kg
- Latch Plate Supplied GH-40344-LP / GH-40344-LPSS

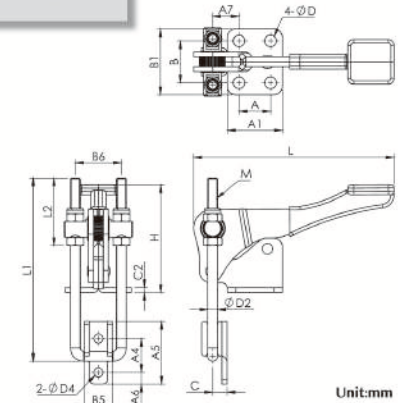
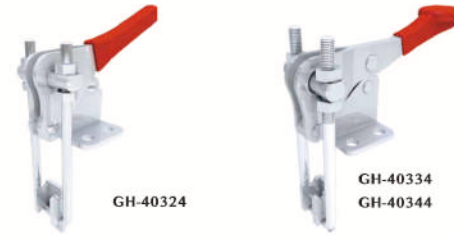

Part No.	A	A1	A7	A4	A5	A6	B	B1	B5	B6	C	C2	D	D2	D4	H	L	L1	L2	M
40324	13	26	10.9	14.3	25.4	4	22	35	13.5	20.5	4.7	2	5.3	4	4.4	5.5	8.1	78.5	26.5	M4xP0.7
40334	19.1	33.3	16	20.6	38.1	7.1	25.4	40	17	28	8.7	3	7.1	6	5.6	65.4	121.5	111	40.5	M6xP1.0
40344	31.8	47.6	20.6	27	54	9.5	36.5	53	30	44.5	12.7	4	8.7	8	8.7	85.5	132.4	154	58	M8xP1.25
40324-SS	STAINLESS STEEL																			
40334-SS	STAINLESS STEEL																			
40344-SS	STAINLESS STEEL																			

GH 40323-R / 40323-RSS

- Holding Capacity 163Kg
- Weight 0.09Kg
- Latch Plate Supplied GH-40323-LP / GH-40323-LPSS

GH 431-R / 431-RSS

- Holding Capacity 318Kg
- Weight 0.27Kg
- Latch Plate Supplied GH-431-LP / GH-431-LPSS

GH 40341-R / 40341-RSS

- Holding Capacity 900Kg
- Weight 0.75Kg
- Latch Plate Supplied GH-40341-LP / GH-40341-LPSS

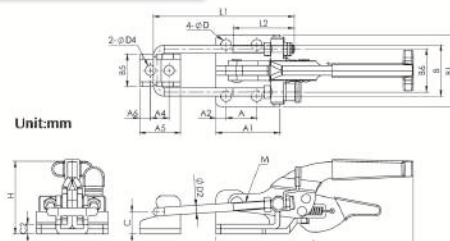
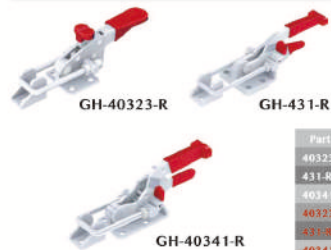

Part No.	A	A1	A2	A4	A5	A6	B	B1	B5	B6	C	D	D2	D4	H	L	L1	L2	M	
40323-R	15.9	26.2	5.2	9.9	19.8	6	19	28.2	13	19	12	2	4.4	4	4.4	37	7.7	5.5	24	M4xP0.7
431-R	19	39.7	6.4	11.5	25.4	6.8	31.8	44.4	20	26.6	13.5	6	6.7	5	6.3	45	121.8	87.5	38	M5xP0.8
40341-R	41.3	60.3	9.5	19.1	38.1	9.5	38.1	54	30.2	44.5	23.4	4	8.6	8	8.5	76.1	171.8	114.5	52	M8xP1.25
40323-RSS	STAINLESS STEEL																			
431-RSS	STAINLESS STEEL																			
40341-RSS	STAINLESS STEEL																			

GH 40324-R

- Holding Capacity 225Kg
- Weight 0.12Kg
- Latch Plate Supplied GH-40324-LP

GH 40334-R

- Holding Capacity 450
- Weight 0.32Kg
- Latch Plate Supplied GH-40334-LP

GH 40344-R

- Holding Capacity 900Kg
- Weight 0.7Kg
- Latch Plate Supplied GH-40344-LP

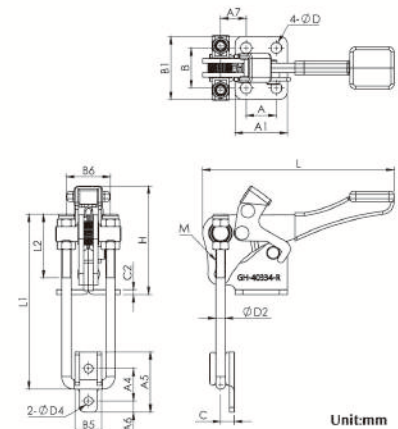

Part No.	A	A1	A7	A4	A5	A6	B	B1	B5	B6	C	C2	D	D2	D4	H	L	L1	L2	M
40324-R	13	26	10.9	14.3	25.4	4	22	35	13.5	20.5	4.7	2	5.3	4	4.4	5.5	8.1	78.5	26.5	M4xP0.7
40334-R	19.1	33.3	16	20.6	38.1	7.1	25.4	40	17	28	8.7	3	7.1	6	5.6	68.9	121.5	111	40.5	M6xP1.0
40344-R	31.8	47.6	20.6	27	54	9.5	36.5	53	30	44.5	12.7	4	8.7	8	8.7	85.5	132.4	154	58	M8xP1.25

GH 40323 series LUB(Longer U Bolt)

©Notice : U Bolt Only

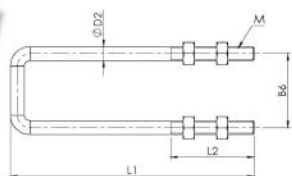

Part No.	Weight	L1	L2	B6	D2	M
40323-LUB	0.03Kg	80	24	19	4	M4xP0.7
431-LUB	0.05Kg	120	38	26.6	5	M5xP0.8
40341-LUB	0.14Kg	160	52	44.5	8	M8xP1.25
40323-LUBSS	STAINLESS STEEL					
431-LUBSS	STAINLESS STEEL					
40341-LUBSS	STAINLESS STEEL					

TOGGLE CLAMPS LATCH TYPE



GH 40820 / 40820-SS

- Holding Capacity | 200Kg
- Weight | 0.11Kg
- Latch Plate Supplied | GH-40820-LP / GH-40820-LPSS

GH 40840 / 40840-SS

- Holding Capacity | 400Kg
- Weight | 0.32Kg
- Latch Plate Supplied | GH-40334-LP / GH-40334-LPSS

GH 40870 / 40870-SS

- Holding Capacity | 700Kg
- Weight | 0.66Kg
- Latch Plate Supplied | GH-40870-LP / GH-40870-LPSS



GH-40870



GH-40840

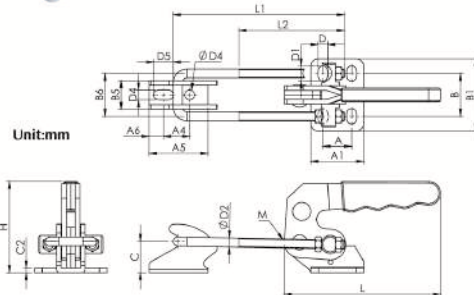

Unit:mm

Part No.	A	A1	A4	A5	A6	B	B1	B5	B6	C	C2	D	D1	D2	D4	D5	H	L	L1	L2	M
40820	13	26	11	23	4.5	21.5	36	16	21	11.6	2.5	5.2	7.7	4	5.2	-	42	68.3	92	55	M6xP0.7
40840	19	35	17.3	39.1	9.6	28.4	48	19	28.5	20.7	3	6.5	10.1	6	6.5	13.1	60.3	103.7	113.5	70	M6xP1.0
40870	32	51	19	40	8	40.5	60	28	44.5	24.4	4	8.5	13	8	8.5	-	85.6	119	150	85	M8xP1.25
40820-SS	STAINLESS STEEL																				
40840-SS	STAINLESS STEEL																				
40870-SS	STAINLESS STEEL																				

GH 40200 / 40200-SS(STAINLESS STEEL)

- Holding Capacity | 200Kg
- Weight | 0.15Kg
- Latch Plate Supplied | GH-40200-LP / GH-40200-LPSS

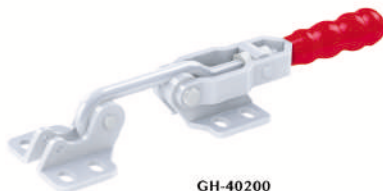

GH-40200

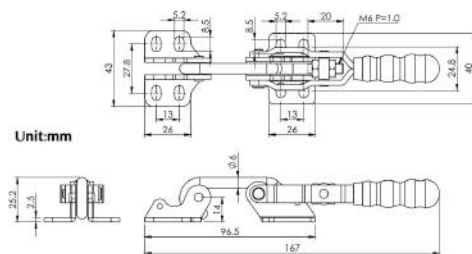

Unit:mm

GH 451 / 451-SS

- Holding Capacity | 170Kg
- Weight | 0.25Kg
- Optional Latch Plate | GH-451-LP / GH-451-LPSS

GH 40371

- Holding Capacity | 340Kg
- Weight | 0.66Kg
- Optional Latch Plate | GH-40371-LP

GH 438 10

- Holding Capacity | 450Kg
- Weight | 1.13Kg
- Optional Latch Plate | GH-43810-LP



GH-451



GH-40371



GH-438 10

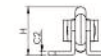
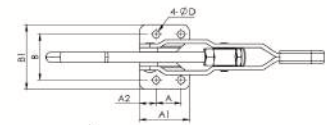

Unit:mm

Part No.	A	A1	A2	B	B1	C	C2	D	D2	H	L	L3	R
451	19	38.1	12.7	34.9	49.2	19	3	5.6	8	36.5	212	58.4	4.9
40371	31.8	47.6	7.9	49.2	65.7	36.7	4	8.7	9.5	57.4	287.5	78.8	7
438 10	28.6	54	12.7	60.3	85.7	46	5	10.3	12.7	66.7	337.5	77.7	8
451-SS	STAINLESS STEEL												

GH 451-LP / 451-LPSS

- Weight | 0.06Kg

GH 40371-LP

- Weight | 0.2Kg

GH 43810-LP

- Weight | 0.34Kg



GH-451-LP



GH-40371-LP



GH-43810-LP

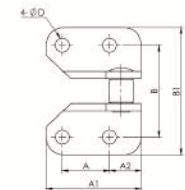

Unit:mm

Part No.	A	A1	A2	B	B1	B2	C	C1	C2	D	D4	H
451-LP	19	38.1	12.7	36.9	51.2	10	19	8	3	5.6	9.5	27
40371-LP	31.8	47.6	7.9	49.2	65.7	12.7	36.7	9.3	4	8.7	14	46
438 10-LP	28.6	54	12.7	60.3	85.7	12.7	46	8	5	10.3	16	54
451-LPSS	STAINLESS STEEL											

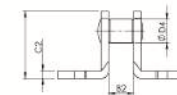

Unit:mm

GH 452

- Holding Capacity | 170Kg
- Weight | 0.23Kg

GH 452-SS (STAINLESS STEEL)

- Holding Capacity | 170Kg
- Weight | 0.23Kg



GH-452

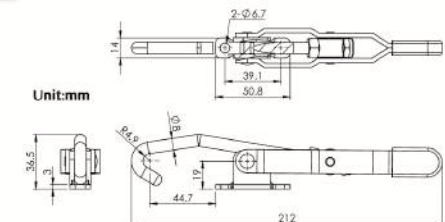

Unit:mm

TOGGLE CLAMPS LATCH TYPE



GH 40370

- Holding Capacity 1818Kg
- Weight 1.23Kg
- Optional Latch Plate GH-40370-LP

GH 40370-LP

- Weight 0.43Kg



Unit:mm

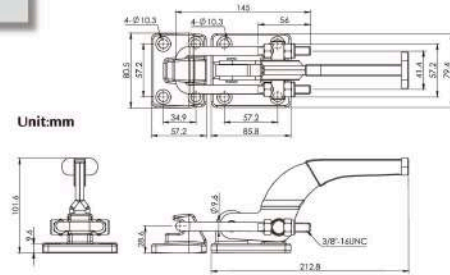

GH 40370-R

- Holding Capacity 1818Kg
- Weight 1.34Kg
- Optional Latch Plate GH-40370-LP



Unit:mm

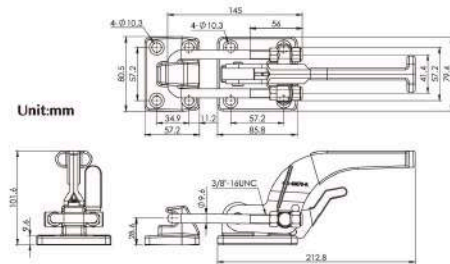

GH 40380

- Holding Capacity 3400Kg
- Weight 1.57Kg
- Optional Latch Plate GH-40370-LP

GH 40380-SS (STAINLESS STEEL)

- Holding Capacity 3400Kg
- Weight 1.57Kg
- Optional Latch Plate GH-40370-LPSS

GH 40370-LPSS (STAINLESS STEEL)

- Weight 0.48Kg



Unit:mm

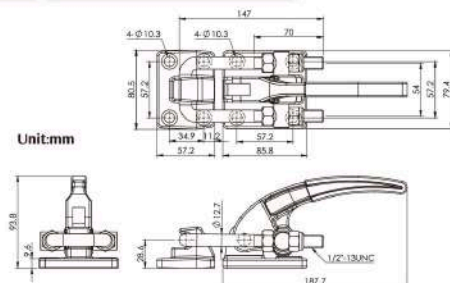

GH 40380-R

- Holding Capacity 3400Kg
- Weight 1.61Kg
- Optional Latch Plate GH-40370-LP

GH 40380-SS (STAINLESS STEEL)

- Holding Capacity 3400Kg
- Weight 1.61Kg
- Optional Latch Plate GH-40370-LPSS



GH-40380-R

Unit:mm

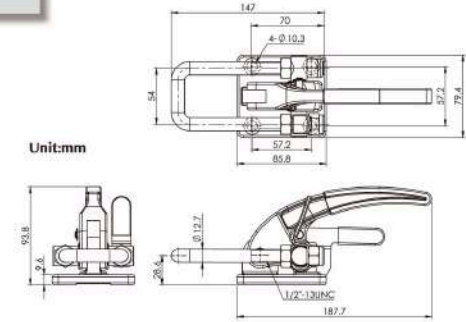

GH 43110 / 43120

- Holding Capacity 170Kg
- Weight 0.18Kg

GH 43110-SS / 43120-SS (STAINLESS STEEL)

- Holding Capacity 170Kg
- Weight 0.18Kg

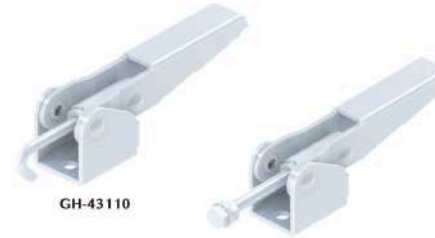

GH-43110

GH-43120

Unit:mm

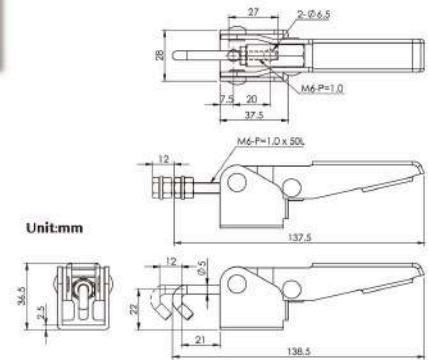

GH 43150

- Holding Capacity 300Kg
- Weight 0.38Kg

GH 43160

- Holding Capacity 300Kg
- Weight 0.38Kg

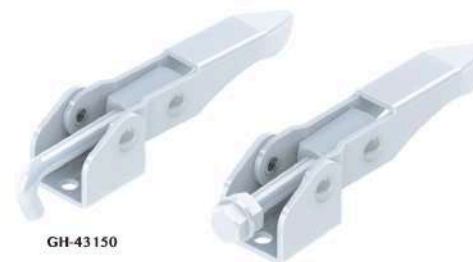

GH-43150

GH-43160

Unit:mm

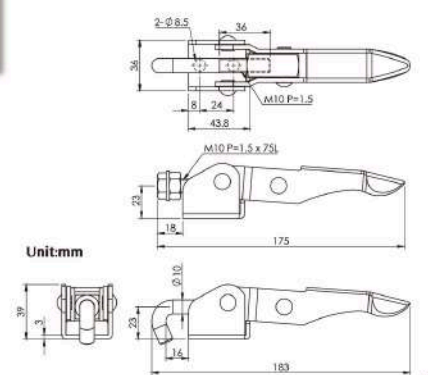

GH 40402 / 40402-SS

- Holding Capacity | 130Kg
- Weight | 0.13Kg



GH-40402

GH 40702

- Holding Capacity | 190Kg
- Weight | 0.25Kg



GH-40702

Part No:	A	A1	A2	B1	C	C2	D	D2	H	H1	L	L1	L2	L3	M	W
40402	36	50	7	20	12	2	6.5	6	23	41.7	183.8	140	40	92.8	M6xP1.0	28
40702	44.5	65.1	8.4	31	18.2	2	6.8	7	32	37.3	214	155.8	50	93.2	5/16"-18UNC	41
40402-SS	STAINLESS STEEL															

Unit:mm

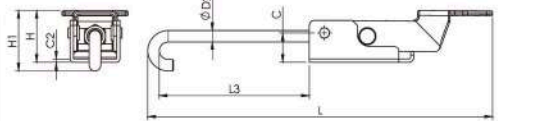

GH 43101

- Holding Capacity | 170Kg
- Weight | 0.3Kg



GH-43101

GH 43311

- Holding Capacity | 540Kg
- Weight | 0.47Kg



GH-43311

Part No:	A	A1	B	B1	C	C1	D	H	L	L3	L5
43101	19	34.8	31.6	44.4	35	12.7	7.1	48.7	211.3	63.7	10
43311	31.8	48.4	45.5	64.4	44.4	16	8.4	63.9	242.2	67.6	9.4

Unit:mm

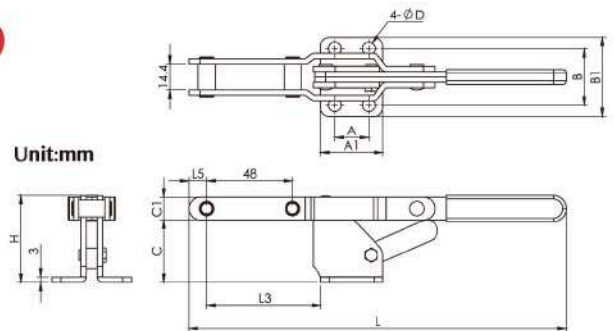

GH 40550

- Holding Capacity | 142Kg
- Weight | 0.27Kg
- Latch Plate Supplied | GH-40550-LP



GH-40580 / GH-40580-LP

GH 40580

- Holding Capacity | 226Kg
- Weight | 1.01Kg
- Latch Plate Supplied | GH-40580-LP

Unit:mm

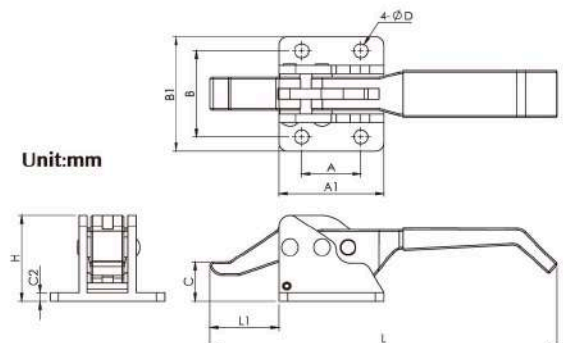

Part No:	A	A1	B	B1	C	C2	D	H	L	L1
40550	19	31	32	42	17.5	4	5.2	33	115.3	22
40580	35	62	51	68	23.2	5	8.5	50.9	205.7	40.9