

GH-A series

Good Hand air-powered clamps are available in three distinctive versions. Vertically acting mechanisms, which share the features of the equivalent manual series, from which they are derived. Straight line action mechanisms providing a push-pull output force.

Swing action cylinder clamps operating on a helix principle.

The obvious benefits offered by air powered clamps are the increased productivity and safety offered by fully automatic hands free operation. Prevention of accidental handle opening even if the air supply is disconnected.

Features include:

- The heavy-duty range has ductile cast iron bases for strength and rigidity.
- Cylinder ports are fitted with air-flow restrictors to control the cycle speed and to provide cushioning at each end of the stroke.
- Chromed piston rods for protection against weld spatter.
- Pivot points are fitted with hardened steel or stainless steel rivets to maintain accuracy and provide a long service life.



GH 10101-A

- Holding Capacity 50Kg
- Bar Opens 82°
- Weight 0.28kg
- Spindle Supplied FC-10138 LP
- Flanged Washers FW-100
- Air Connection Size 1/8 PT
- Cylinder Bore 20mm
- Max Cylinder Air Pressure 10kgf/cm²

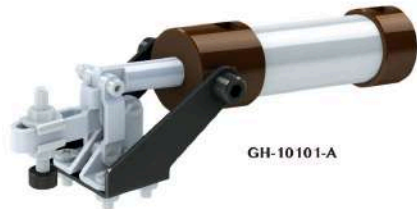

GH-10101-A

Unit:mm

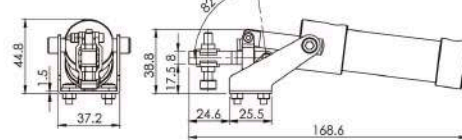

GH 12130-A / 12132-A

- Description Short U-Bar / Long U-Bar
- Holding Capacity 227Kg
- Bar Opens 92°
- Weight 0.87kg / 0.88kg
- Spindle Supplied FC-56212
- Flanged Washers FW-516
- Air Connection Size 1/8 PT
- Cylinder Bore 30mm
- Max Cylinder Air Pressure 10kgf/cm²



GH-12130-A

Unit:mm

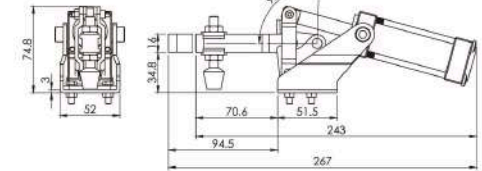

GH 12050-A

- Holding Capacity 91Kg
- Bar Opens 95°
- Weight 0.61kg
- Spindle Supplied FC-14134
- Air Connection Size 1/8 PT
- Cylinder Bore 30mm
- Max Cylinder Air Pressure 10kgf/cm²



GH-12050-A

GH 12050-UA

- Holding Capacity 91Kg
- Bar Opens 95°
- Weight 0.62kg
- Spindle Supplied FC-14134
- Flanged Washers FW-142
- Air Connection Size 1/8 PT
- Cylinder Bore 30mm
- Max Cylinder Air Pressure 10kgf/cm²



GH-12050-UA

Unit:mm

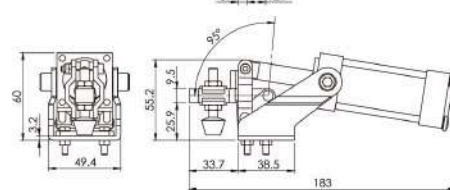

GH 12265-A

- Holding Capacity 340Kg
- Bar Opens 86°
- Weight 1.69Kg
- Spindle Supplied FC-38312
- Flanged Washers FW-380
- Air Connection Size 1/8 PT
- Cylinder Bore 40mm
- Max Cylinder Air Pressure 10kgf/cm²



GH-12265-A

Unit:mm

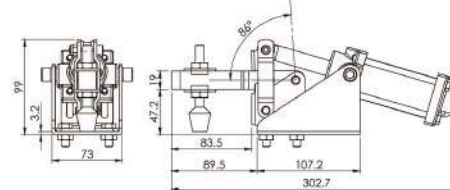

GH 12275-A

- Holding Capacity 340Kg
- Bar Opens 86°
- Weight 1.71Kg
- Spindle Supplied FC-38312
- Flanged Washers BR-380
- Air Connection Size 1/8 PT
- Cylinder Bore 40mm
- Max Cylinder Air Pressure 10kgf/cm²



GH-12275-A

Unit:mm

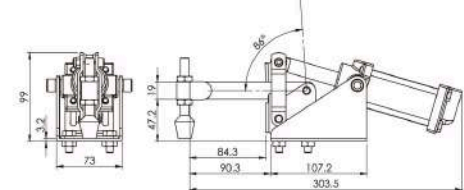

GH 10247-A

- Holding Capacity 450Kg
- Bar Opens 100°
- Weight 3.73Kg
- Spindle Supplied SA-12300
- Flanged Washers FW-120
- Air Connection Size 1/8 PT
- Cylinder Bore 50mm
- Max Cylinder Air Pressure 10kgf/cm²



GH-10247-A

GH 10249-A

- Holding Capacity 450Kg
- Bar Opens 100°
- Weight 3.7Kg
- Spindle Supplied SA-12300
- Flanged Washers FW-120
- Air Connection Size 1/8 PT
- Cylinder Bore 50mm
- Max Cylinder Air Pressure 10kgf/cm²



GH-10249-A

GH 36301-A

- Holding Capacity 45Kg
- Bar Opens 6.8mm
- Weight 0.26Kg
- Spindle Supplied SA-042007(NYLON)
- Air Connection Size 1/8 PT
- Cylinder Bore 20mm
- Max Cylinder Air Pressure 10kgf/cm²



GH-36301-A

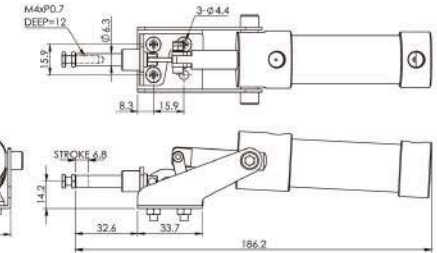

GH 36003-A

- Holding Capacity 272Kg
- Bar Opens 18.3mm
- Weight 0.94Kg
- Spindle Supplied SA-085012
- Air Connection Size 1/8 PT
- Cylinder Bore 30mm
- Max Cylinder Air Pressure 10kgf/cm²



GH-36003-A

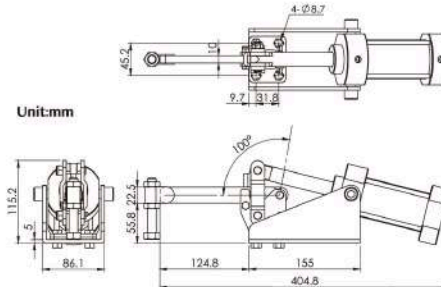
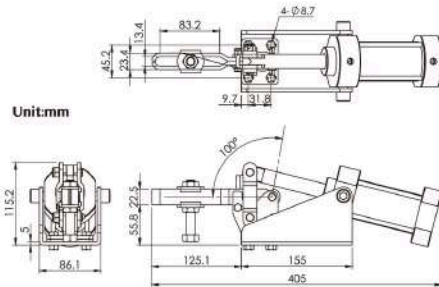
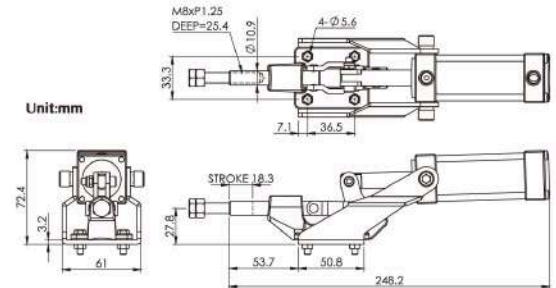

GH 20820-A

- Holding Capacity 100Kg
- Bar Opens 90°
- Weight 0.96Kg
- Spindle Supplied FC-S6212
- Flanged Washers FW-516
- Air Connection Size 1/8 PT
- Cylinder Bore 30mm
- Max Cylinder Air Pressure 10kgf/cm²



GH-20820-A

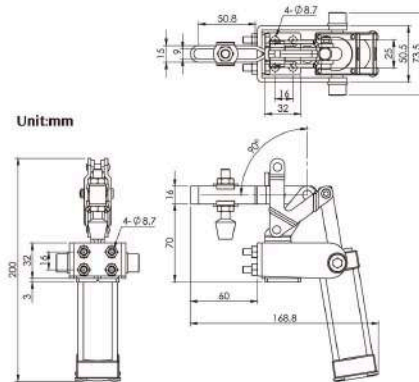

GH 305-EA

- Holding Capacity 386Kg
- Bar Opens 23.1mm
- Weight 1.53Kg
- Spindle Supplied SA-105015
- Air Connection Size 1/8 PT
- Cylinder Bore 30mm
- Max Cylinder Air Pressure 10kgf/cm²



GH-305-EA

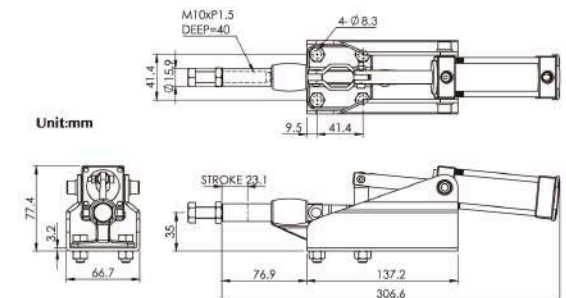

GH 30600HL-A

- Holding Capacity 600Kg
- Bar Opens 25mm
- Weight 1.23Kg
- Spindle Supplied SA-086512
- Air Connection Size 1/8 PT
- Cylinder Bore 25mm
- Max Cylinder Air Pressure 9kgf/cm²



GH-30600HL-A

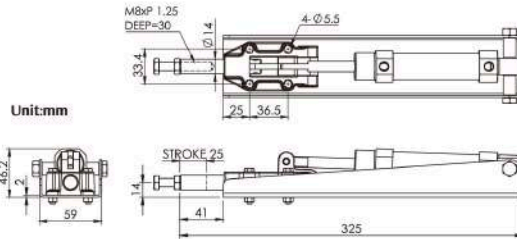

GH 31200HL-A

- Holding Capacity 1200Kg
- Bar Opens 32mm
- Weight 3.37Kg
- Spindle Supplied SA-107515
- Air Connection Size 1/8 PT
- Cylinder Bore 32mm
- Max Cylinder Air Pressure 9kgf/cm²



GH-31200HL-A

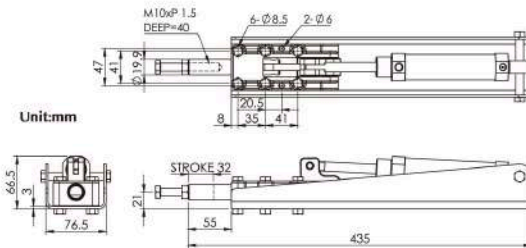

GH 32500HL-A

- Holding Capacity 2500Kg
- Bar Opens 50mm
- Weight 7.03Kg
- Spindle Supplied SA-127517
- Air Connection Size 1/8 PT
- Cylinder Bore 40mm
- Max Cylinder Air Pressure 9kgf/cm²



GH-32500HL-A

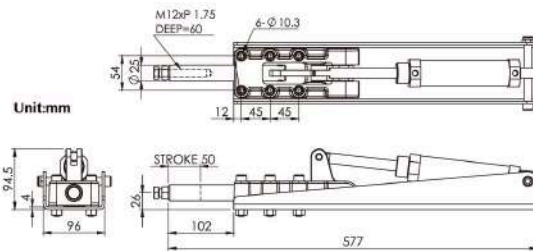

GH 30600PR-A

- Holding Capacity 600Kg
- Bar Opens 25mm
- Weight 4.2Kg
- Spindle Supplied SA-086512
- Air Connection Size 1/8 PT
- Cylinder Bore 25mm
- Max Cylinder Air Pressure 9kgf/cm²

GH-30600HL-A

GH-30600MB



GH-30600PR-A

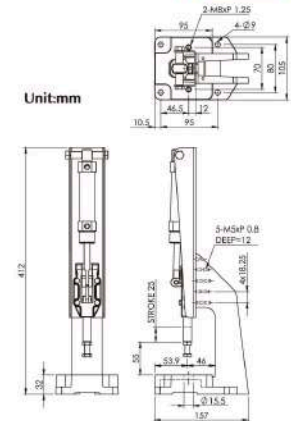

GH 31200PR-A

- Holding Capacity 1200Kg
- Bar Opens 32mm
- Weight 10Kg
- Spindle Supplied SA-107515
- Air Connection Size 1/8 PT
- Cylinder Bore 32mm
- Max Cylinder Air Pressure 9kgf/cm²

GH-31200HL-A

GH-31200MB



GH-31200PR-A

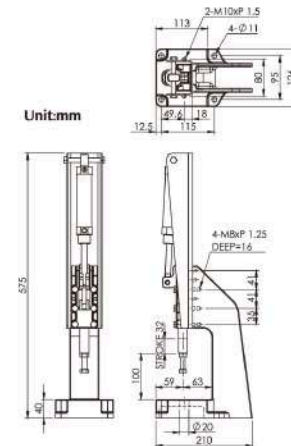

GH 32500PR-A

- Holding Capacity 2500Kg
- Bar Opens 50mm
- Weight 19.62Kg
- Spindle Supplied SA-127517
- Air Connection Size 1/8 PT
- Cylinder Bore 40mm
- Max Cylinder Air Pressure 9kgf/cm²

GH-32500HL-A

GH-32500MB



GH-32500PR-A

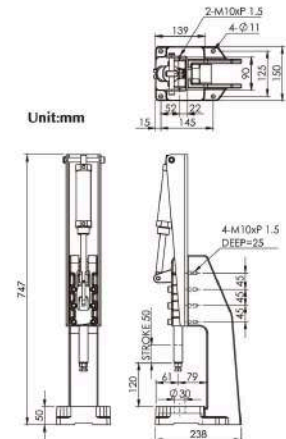

GH 36330-A

- Holding Capacity 1136Kg
- Bar Opens 30.4mm
- Weight 2.66Kg
- Spindle Supplied SA-105015
- Air Connection Size 1/8 PT
- Cylinder Bore 40mm
- Max Cylinder Air Pressure 10Kgf/cm²



GH-36330-A

Unit:mm

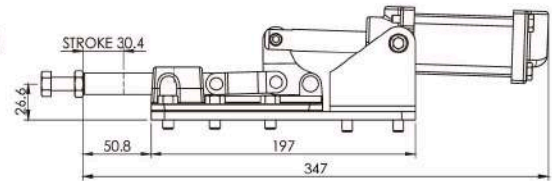
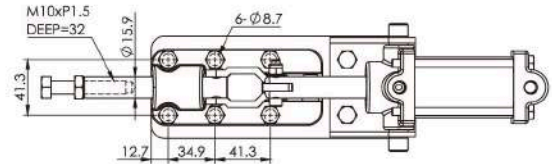
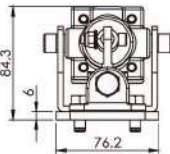

GH 702-CA

- Holding Capacity 200Kg
- Bar Opens 83°
- Weight 1.47Kg
- Air Connection Size 1/8 PT
- Cylinder Bore 30mm
- Max Cylinder Air Pressure 10Kgf/cm²



GH-702-CA

GH 702-DA

- Holding Capacity 500Kg
- Bar Opens 64°
- Weight 3Kg
- Air Connection Size 1/8 PT
- Cylinder Bore 40mm
- Max Cylinder Air Pressure 10Kgf/cm²

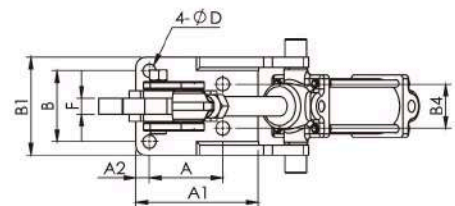

Unit:mm

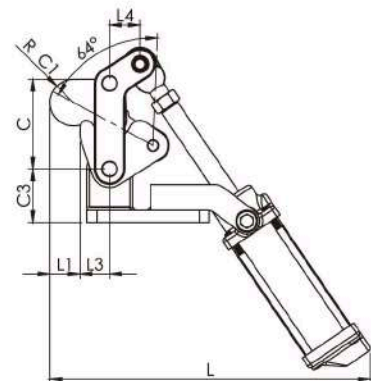
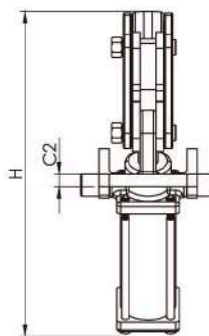

Part No:	A	A1	A2	B	B1	B4	C	C1	C2	C3	D	F	H	L	L1	L3	L4
702-CA	30	80	8	41	58	-	51.5	13.5	10	34	8.5	8	161	247	16.5	23	16.4
702-DA	60	100	11	58	80	36	73.8	19	10	43.7	11	13	264	262	24.6	24.2	25